

Port of Everett

HAT ISLAND COMMUNITY

Application for Digital Parking Permit Instructions

The Port of Everett and its partner LAZ Parking have streamlined the Parking Permit process using a digital permit. As such, you will not have a physical permit in your vehicle as the state license plate on your car will be read by our system and you are able to register multiple cars on one permit so long as only one car is parked using the permit at a time. For 2024, the Port / LAZ Parking is manually entering permits for Hat Island.

Once you provide the needed information with your payment, LAZ will process your application and, once authorized, you will receive an email confirming your permit is activated. This may take up to 48 business hours.

Hat Island parking is located within the general visitor parking areas of South Marina. A parking map is shown below showing the locations you may park once you have your email confirming the activation of the digital permit.

If at any time you have questions about the process or rules you can email see this link for information: contact portparking@lazparking.com or call the office at (425) 322-4623. If you receive a violation and believe it was in error, please don't hesitate to contact us.

START BY COLLECTING THE INFORMATION REQUIRED in the application:

- **Make, license plate and state of registration for each vehicle** – you may register more than one vehicle per permit but only one can use the permit at a time.
- **Hat Island lot number and address used to confirm your eligibility for permit. Permits are available to those who own property or their dependents.**
- **Email address** -*Please note if you do not have an email, please indicate so and your confirmation will be mailed.*
- Primary address
- **A contact phone number** so we are able to reach you if there is an issue with your permit or vehicle. Please use one you would have access to when traveling as attempt to contact you if there is a serious problem.

HAT ISLAND COMMUNITY PERMIT APPLICATION

Send application and payment by check via US Mail to:		
Att: Laz Parking 1205 Craftsman Way Suite 102A Everett, WA 98201		
<u>Check box select permit:</u>		
<input type="checkbox"/> ANNUAL 2024	\$869.72	
<input type="checkbox"/> Early Bird Special ANNUAL 2024		\$826.22 (Offered through 2/29/2024 if one of 45 applications is available)
<input type="checkbox"/> MONTHLY RATES (purchased month-to-month only)	\$ 73.00 per month (1 st and 4 th Quarter) \$ 92.00 per month (2 nd and 3 rd Quarter)	1st Q: January, February March 4th Q: October, November, December 2nd Q: April, May, June 3rd Q: July, August, September
SHORT TERM (day-to-day parking)	<u>Do not send in an application for this parking term.</u> Just simply park in general visitor (Lot 8 as indicated on the Map) and pay fee as indicated on signs, if any. First two hours free; pay to park up to 29 days thereafter. Payment online, smart phone ap, at the payboxes located in the Visitor Parking section.	

Only your name is needed to be filled out if you setup last year. Any info you include on this form will be updated on your account. All new applications will need to fill these out.

Hat Island Lot#:	
Car Owner's Full name (first and last)	
Email:	
Cell phone:	
Address: # Street	
City/State/ZIP	
Vehicle #1 Information	License Plate

	Issuing state
	Make
Vehicle #2 Information <i>Note, only one vehicle may park in the lot at a time.</i>	License Plate
	Issuing State
	Make

Hat Island Monthly or Annual Permit Parking Location

These permits are valid in the South Marina Lot 8 shown on the figure below in blue highlight.

With this permit, you may park up to 29 days without moving your vehicle. On special event days, you are not required to pay the fee.

Please note: Do not park in the Marina Village 2-hour parking for greater than 2 hours, or in the Marina Slipholder reserved parking areas. All vehicles must be street legal and operational. Vehicles may not be covered.

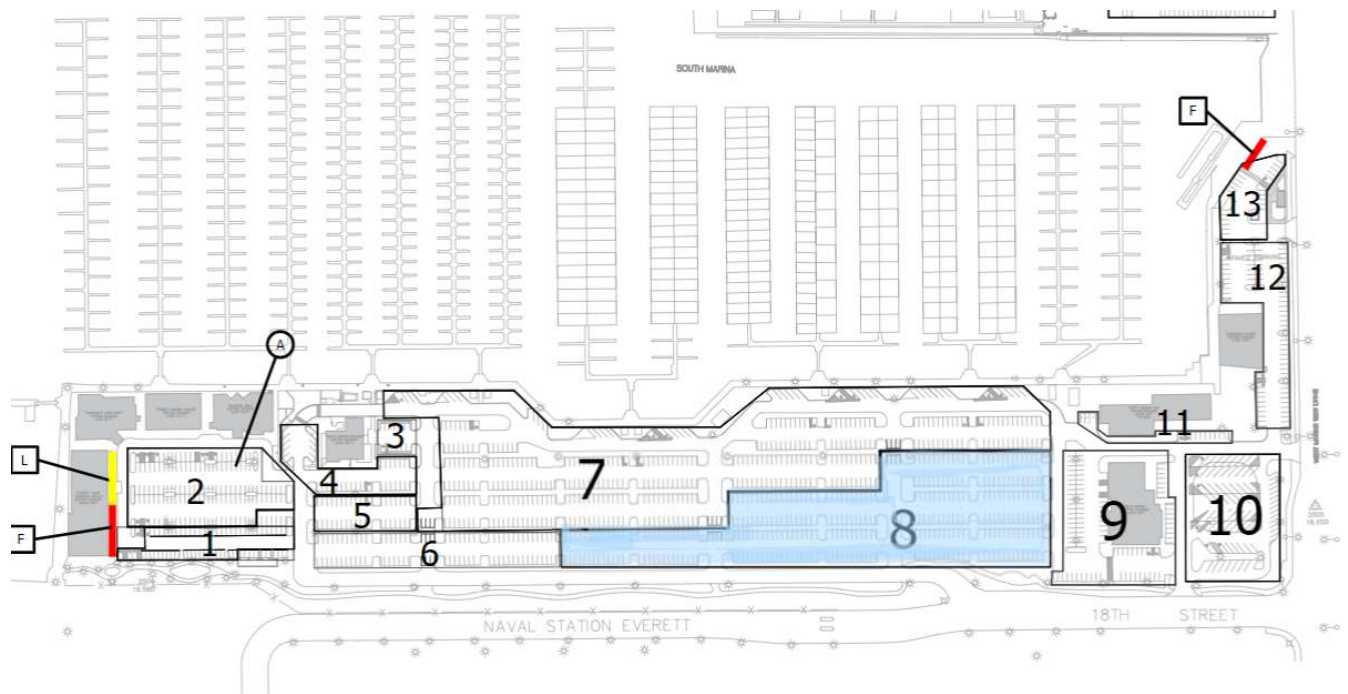

Figure 1 South Marina – Lot 8 In blue

Hat Island Monthly or Annual Permit Terms

The payments for parking are generally non-refundable, once paid you have agreed to to the term length associated with the parking. Annual Permits are good until December 31st of the year purchased and Monthly Permits are only good for the month purchased. For example, if a monthly permit is purchased on August 31st, the person has purchased a monthly permit and the term for that parking ends on September 30.

There will not be advanced purchasing of monthly parking in 2024. If you are purchasing monthly parking, you will need to activate it prior to the month you are parking and then deactivate it when you no longer are parking.

There are only 45 guaranteed parking spaces, these are reserved for Annual Permit holders only. While there may not ever be an overflow of Lot 8 (as indicated on the previous page) parking, the Port and Laz reserve the right to cancel Monthly Permits or stop adding Monthly Permits to account for demand on Lot 8 visitor parking. The Monthly Permits that have been open the longest will have priority in determining which Monthly Permits to cancel.